

**33C**

Options: 089 | 096 | 113 | 126 | 194 | 220 | 304 | 470 | 471 | 580 | 671 | 833

**TOP FLOORPLAN FEATURES**

- Sleeps up to 6
- Dual Dash Monitors
- Fiberglass Shower w/Skylight
- 2000W Inverter
- Exterior Entertainment Center

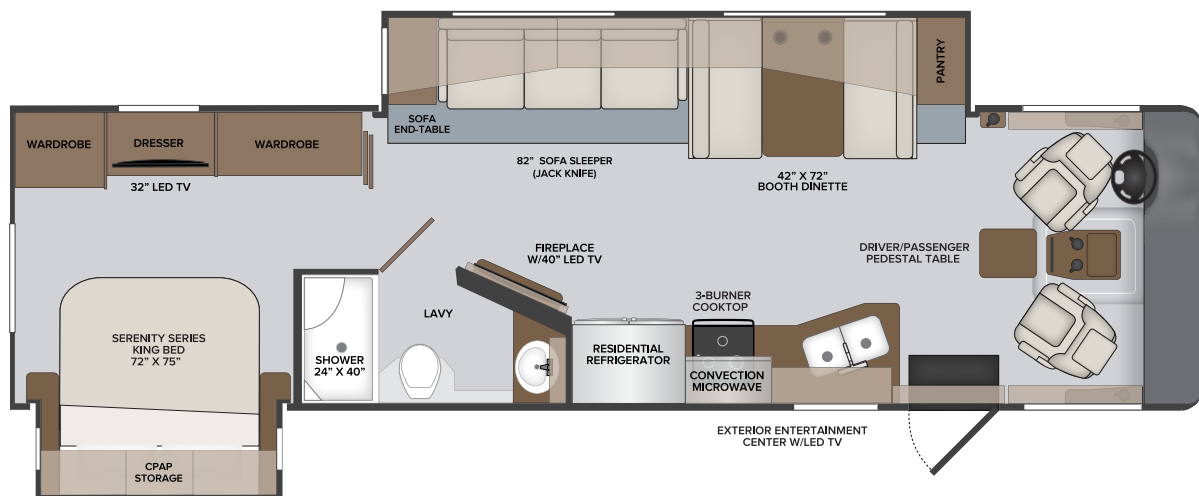
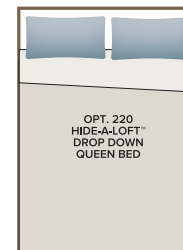
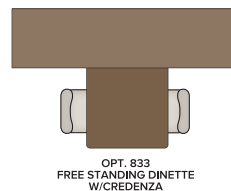
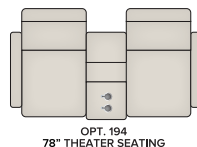
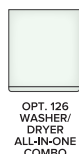

FORD® CHASSIS

Model: Ford®

Engine: 7.3L Triton V8

Transmission: Ford® 6-Speed, Automatic w/Overdrive

Alternator: 175 Amp

Torque: 468 lb.-ft. @ 3,000 RPM

Horsepower: 350HP @ 3,900 RPM



**VACATIONER 33C OPTIONS**

089	Upgraded WiFi Package	194	Theater Seating Sofa	471	Steering Stabilizer System
096	KING® Universal Satellite System	220	Hide-A-Loft™ Drop Down Queen Bed	580	Collision Mitigation
113	Range -3 Burner Drop-in w/Oven	304	Solar Electrical Panel (265w)	671	Manual Power Cord Reel
126	Washer/Dryer — All in one combo	470	SumoSprings® - Front/Rear	833	Free Standing Dinette

**2022**

Class A Gas  
**VACATIONER**

**33C**  
FLOORPLAN